



Holy Trinity CofE School

Staff Presentation



Holy Trinity CofE School Agenda

1. Introductions & Our Approach
2. Site Analysis
3. Brief & Need
4. Proposed Design Option
5. Phasing

Holy Trinity CofE School Our Approach

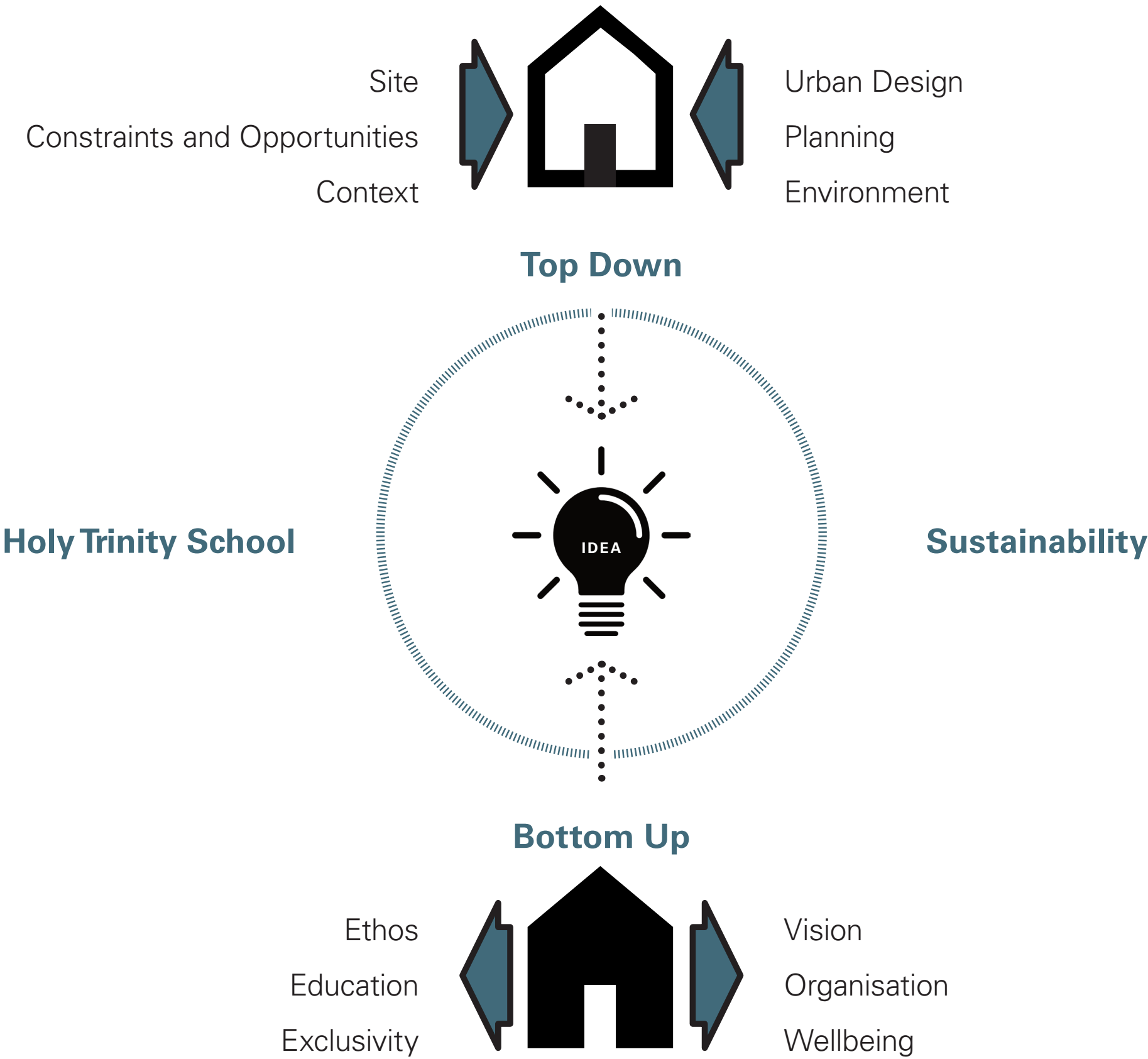

Holy Trinity CofE School Site Analysis | Location



Holy Trinity CofE School Site Analysis | Site



Holy Trinity CofE School Site Analysis | Environment

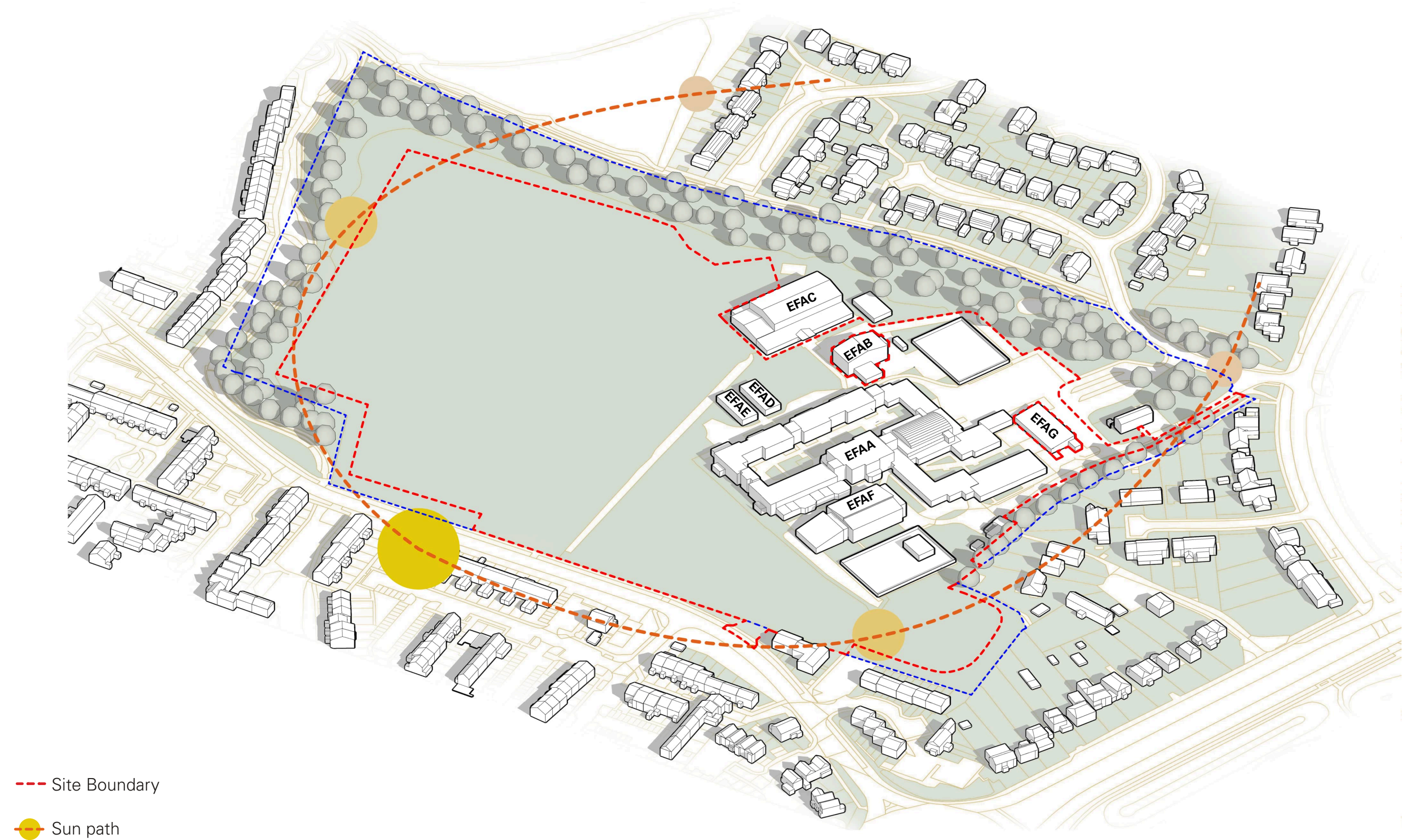

Holy Trinity CofE School Site Analysis | Access & Transport

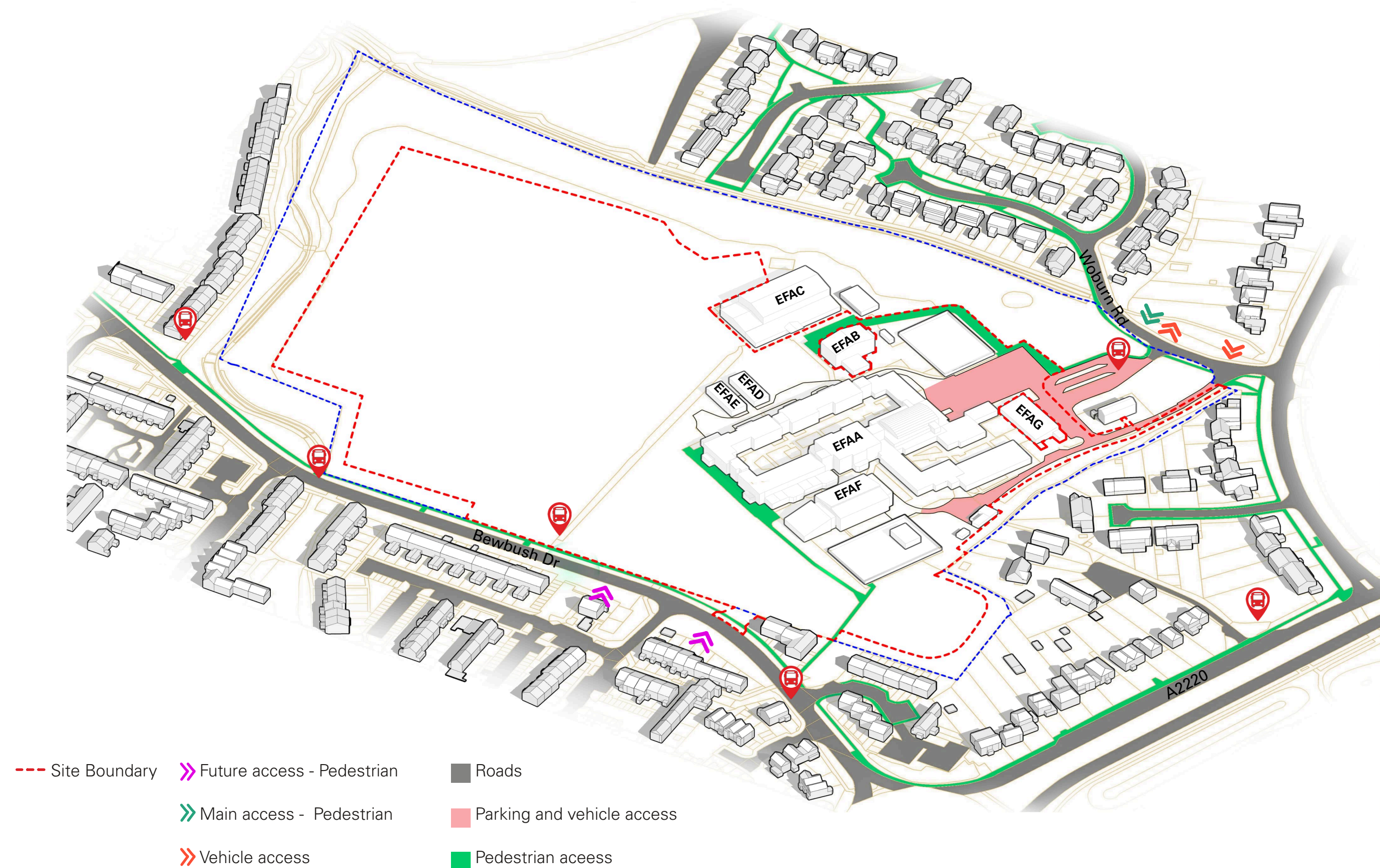

Holy Trinity CofE School Brief & Need

Holy Trinity CofE School accommodated a bulge class (an extra 30 pupils), which started from September 2022, due to the need in the local area.

The Local Authority will be formally expanding their accommodation to allow for future growth, resulting in a permanent increase in its PAN to an 8FE school. This is based on a consultation process carried out in 2023.

The Local Authority statutory consultation timescales suggest this will be agreed and effective from September 2025. The new scheme is therefore to be designed for 240 PAN (8FE) and sixth form estimated at 300, with basic need funding being provided from the LA.

Holy Trinity CofE School Brief & Need | Existing Facilities



Holy Trinity CofE School Brief & Need | School Specific Brief

General Background

- The school as been identified on the national School Rebuilding Programme as having building stock in a poor condition and of need of development.
- The main land and buildings are owned by The Chichester Diocesan Fund and Board of Finance and the playing fields are owned by West Sussex Council.
- The school curriculum approach is that of a Church of England Faith School.
- The current school accommodates 1,410 pupils including 300 sixth form.
- The brief has been designed to allow the school to expand to 1,500 pupils.
- The is approximately 196 staff, of which 175 are FTE.
- There is a planned expansion of an additional form of entry for each year.
- The new build area is around 9,300m², with around 1,500m² refurb of EFAF.

Site and Access

- The site is currently accessed by pedestrians from the south via Burbeach Close
- There is vehicular access from the north via Woburn Road using a one way system within the school.
- There is a live bus stop located in the north of the site outside the secure zone.
- The school have a desire to have additional vehicular access to the south.

Holy Trinity CofE School Brief & Need | School Specific Brief

Adjacencies

- Departments are to be blocked together as follows; Maths, English, Science, Health & Wellbeing (Drama, Music, Sports), DT & Art, Business & ICT, Humanities (including French) and RPE.
- Technology rooms are to be designed to work with the schools existing specialist equipment that includes a ceramic chip forge and brazing.
- A Dark Room and Kiln are to be provided as part of the DT & Art department.
- An interview room is required off the main entrance with an additional door from the secure side.
- The conference room is also to be located off the main entrance and have access from both the secure and non-secure side.
- The existing Chichester stones that are in reception are to be moved to the Chapel.
- The Assembly Hall is to have bleacher seating and a lighting rig for performances and is to be adjacent to the Drama studio and close to the main entrance.
- Classrooms to have flexible FF&E where possible, eg. movable stations in science.
- Staff spaces are to be distributed to provide good passive supervision.
- Reprographics is to be allocated as an additional staff or SEN area.
- Lockers are to be used for charging iPads only.
- Toilets to be blocked together and open plan.

Holy Trinity CofE School Proposed Design Option | Design Drivers

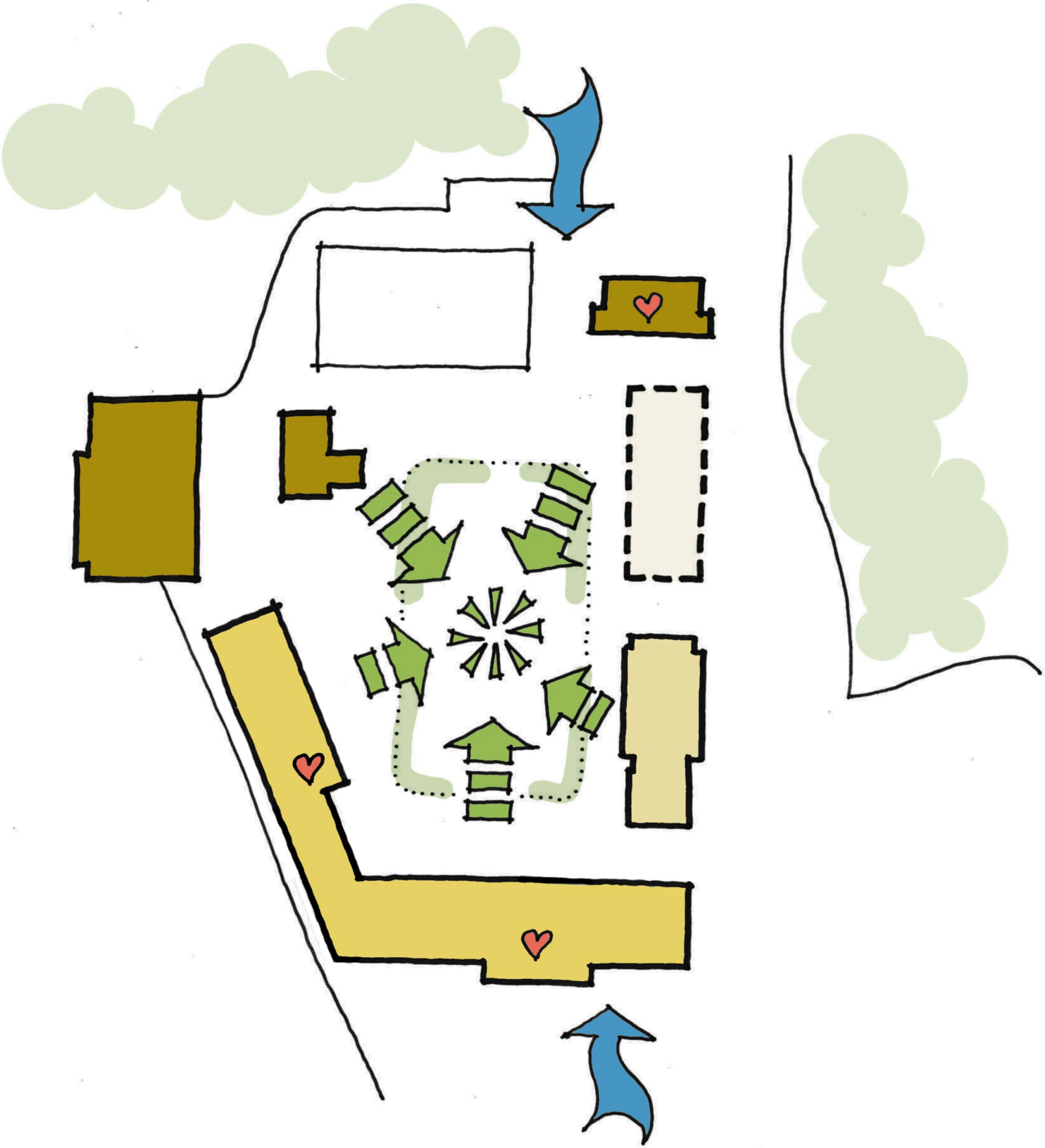

Holy Trinity CofE School Proposed Design Option | Massing

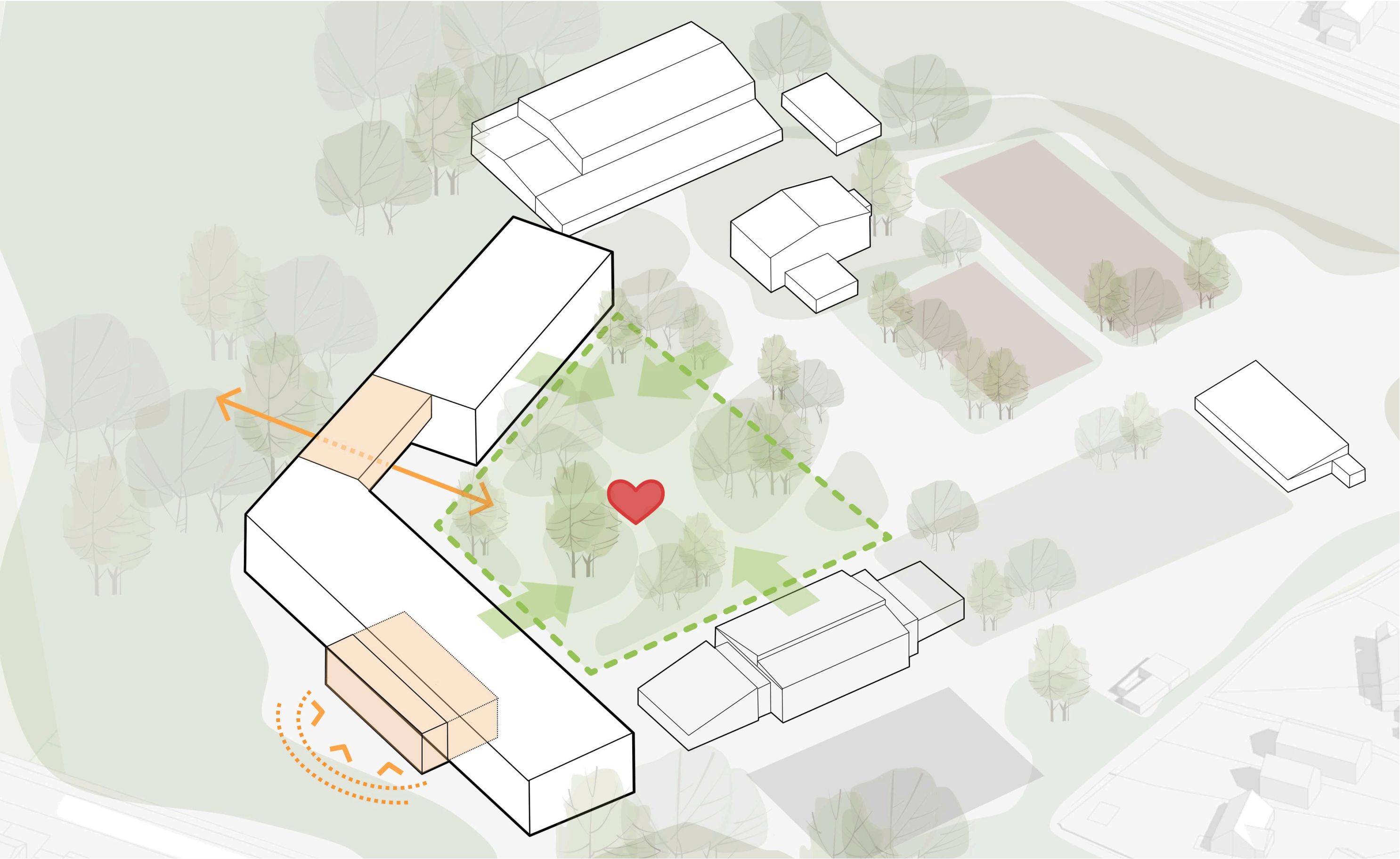

Holy Trinity CofE School Proposed Design Option | Landscape

The Proposals



- Maximised Student Space with Good Supervision

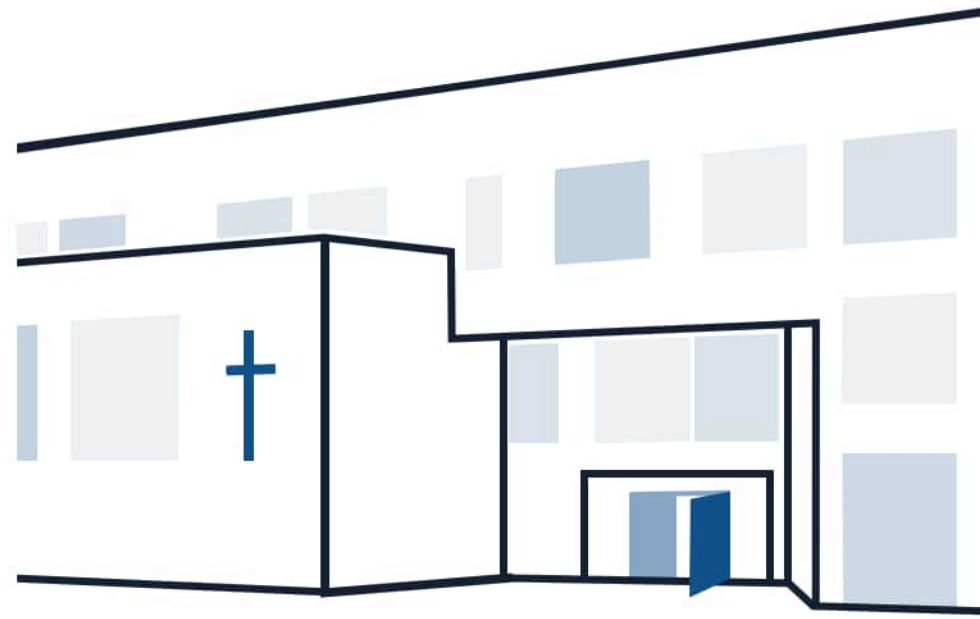

- Arrival for All at New Reception Moving Focus to Community to South via pedestrian and cycle path



- Improved Pedestrian Safety
- Strategic Car Park Relocation to the South
- Parking Number Increased from 85 to 104 Spaces for Growing Student Population



- Sports Consolidated & Modernised
- BB103 Hard Outdoor PE Area Increased



- >10% Biodiversity Net Gain Delivered
- Reduced Environment Impact

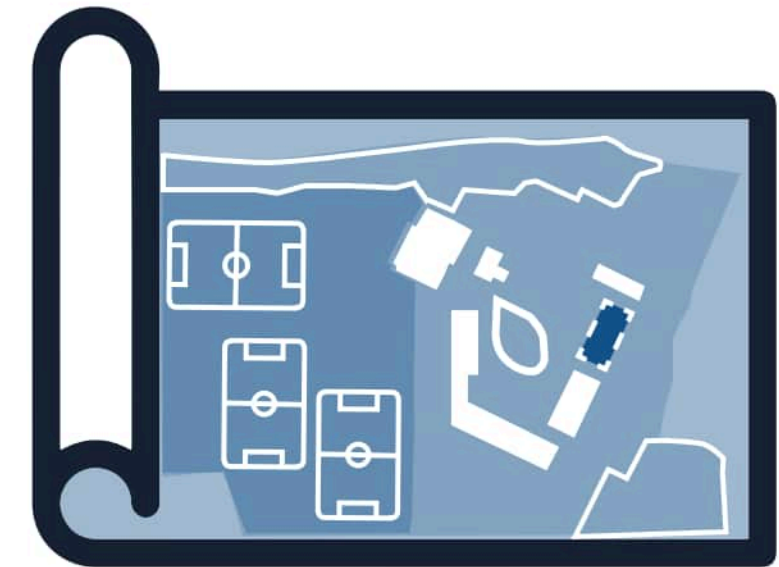

- Future-Proofed - access and expansion
- New Outdoor Learning Area
- Special Spaces Created for Memorial, Chapel, Covered Dining, Spectators & Sixth Form

Holy Trinity CofE School Proposed Design Option | Landscape

Proposed Site Plan



Holy Trinity CofE School Proposed Design Option | Landscape

Safeguarding

- Clear safeguarded areas focused on a central campus courtyard
- Welcoming approach from Bewbush Drive
- Consolidated safeguarded student space through movement of parking moved to the southern MUGA

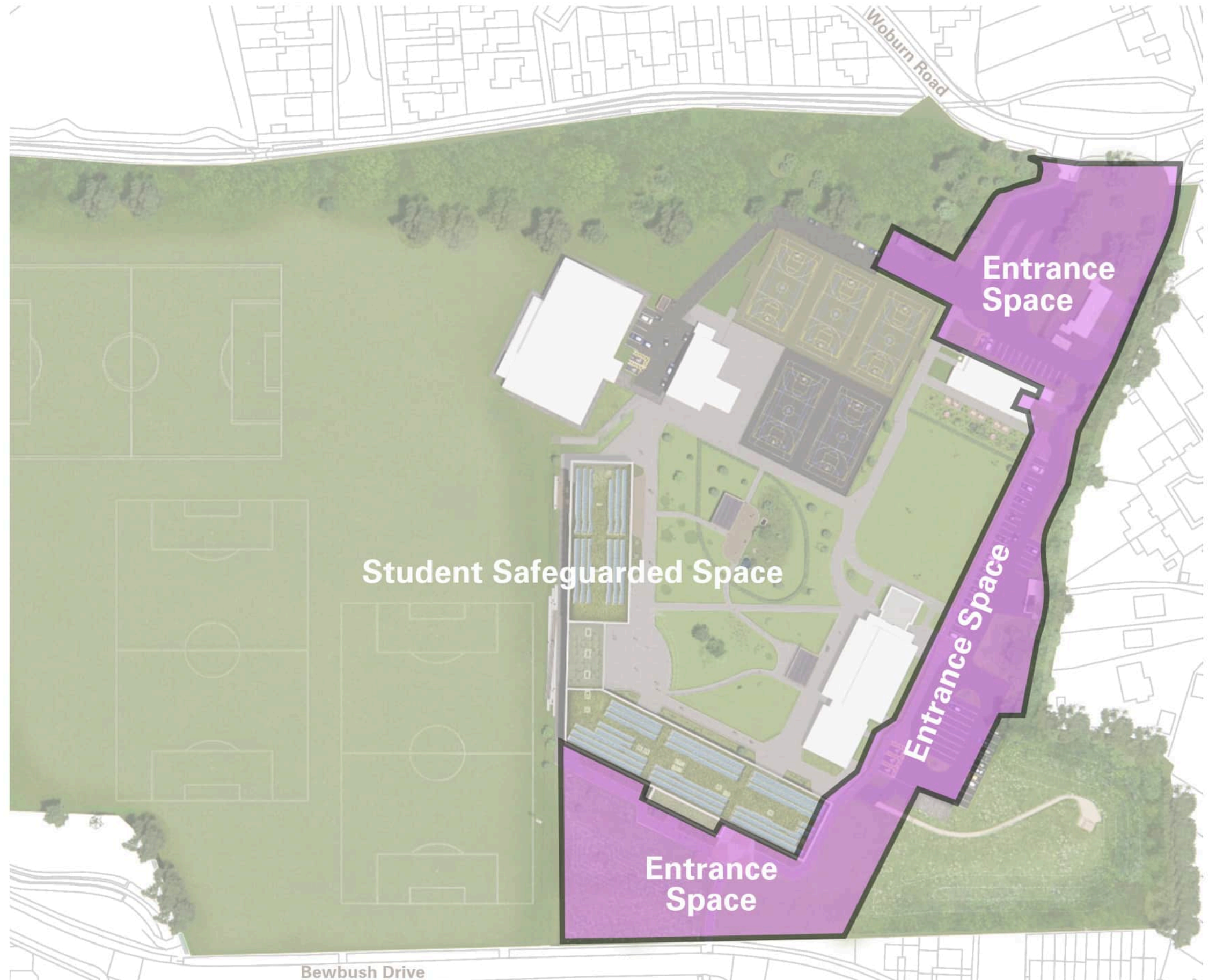

Holy Trinity CofE School Proposed Design Option | Landscape

Use

- Sports Facility Enhancements (Playing Field & Multi-Use Games Area)
- Sports Consolidated & Expanded
- Maximised Student Space with Good Supervision
- Special Spaces Created for Memorial, Chapel, Outdoor Covered Dining & Sixth Form
- New Outdoor Learning Area



Holy Trinity CofE School Proposed Design Option | Landscape

Fencing



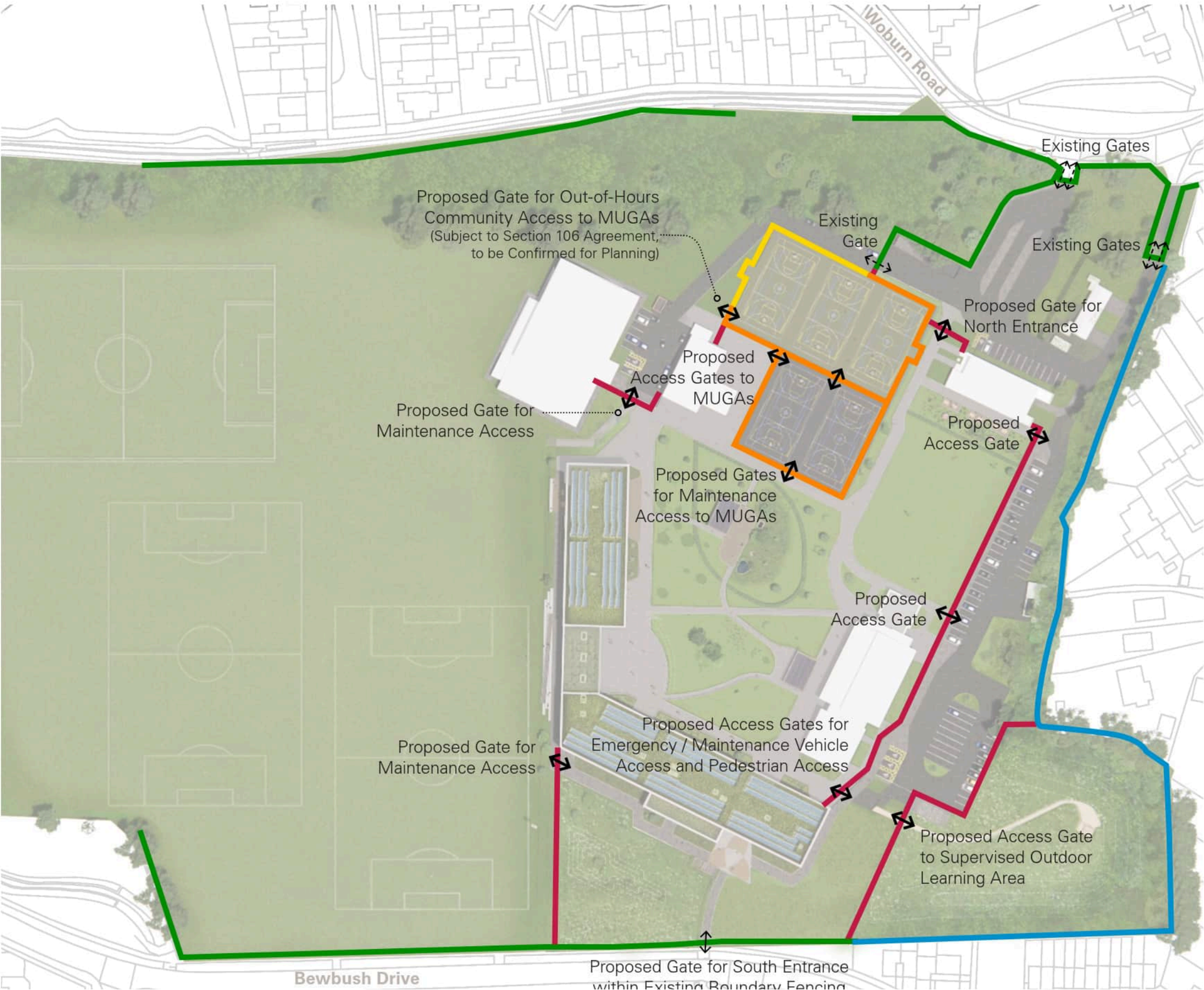

Key

- Existing 2.4m high Railings & Weldmesh Fence
- Existing Varied Garden Boundary Fencing
- Proposed 2.4m high Weldmesh Fence
- Existing 3m Sports Weldmesh Fence
- Proposed 3m Sports Weldmesh Fence with rebound to 1.2m height



Holy Trinity CofE School Proposed Design Option | Landscape

Access | Student & Staff

- Key**
-  Pedestrian Access from Streets & Public Area
 -  Internal Pedestrian Access
 -  Cycle Access
 -  Car Park
 -  Supervised Internal Pedestrian Access

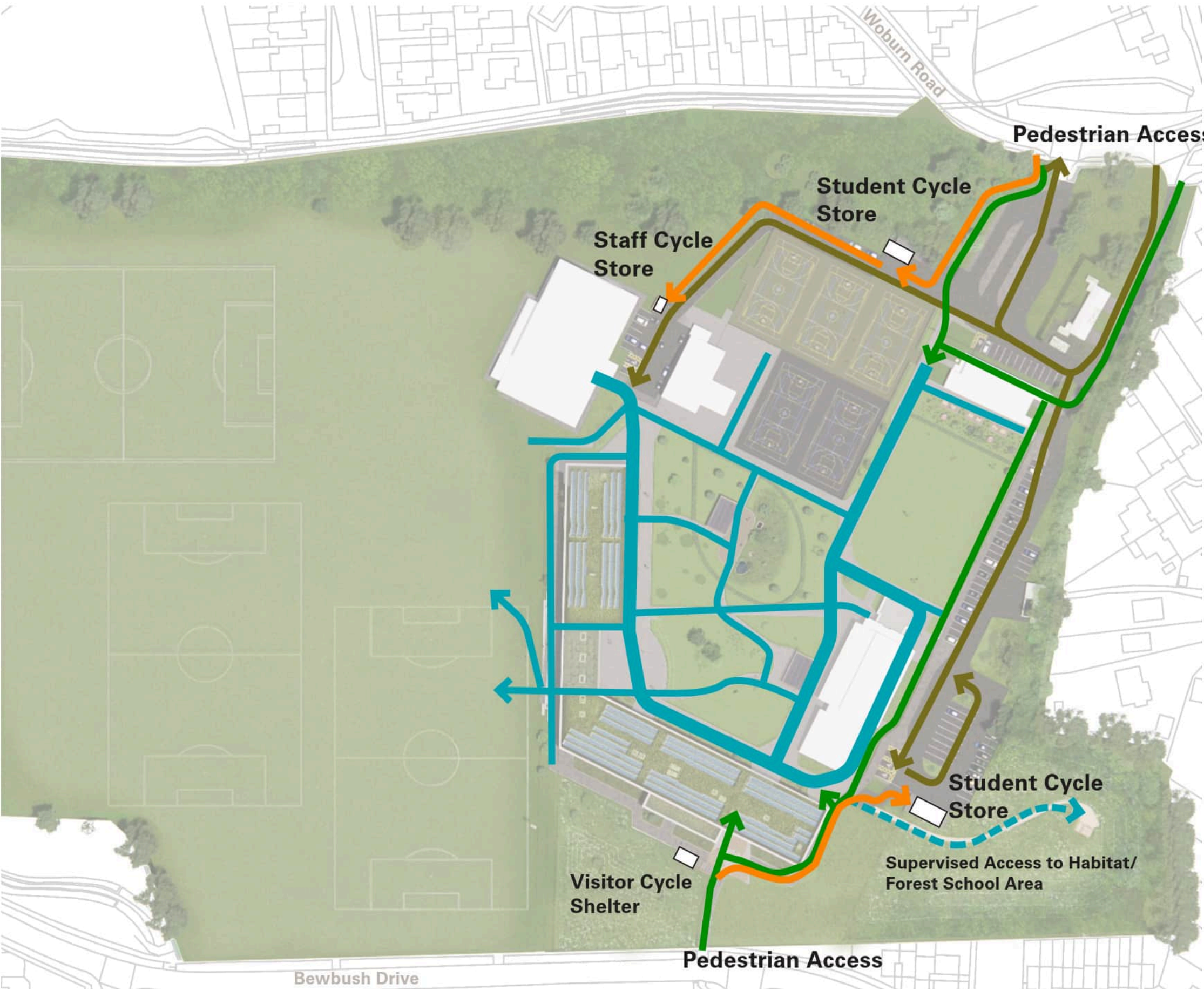

Holy Trinity CofE School Proposed Design Option | Landscape

Access | School Visitor

Key

-  Pedestrian Access from Streets & Public Areas
-  Cycle Access
-  Car Park



Holy Trinity CofE School Proposed Design Option | Landscape

Access | Community Key



-  Pedestrian Access from Streets & Public Areas
-  Cycle Access
-  Car Park



Holy Trinity CofE School Proposed Design Option | Landscape

Access | Fire

Key

-  Fire Tender Access Routes
-  Proposed Muster Points



Holy Trinity CofE School Proposed Design Option | Landscape

Access | Maintenance, Refuse & Deliveries

Key

- Reception, DT Deliveries & Maintenance
- Kitchen Deliveries
- Building Maintenance Access
- Landscape Maintenance Access
- Refuse Truck



Holy Trinity CofE School Proposed Design Option | Landscape

Visual



Holy Trinity CofE School Proposed Design Option | Landscape

Main Entrance Visual



Holy Trinity CofE School Proposed Design Option | Landscape

Memorial Garden Visual



Holy Trinity CofE School Proposed Design Option | Landscape

Memorial Garden Visual



Holy Trinity CofE School Proposed Design Option | Landscape

Multi-Use Games Area Visual



Holy Trinity CofE School Proposed Design Option | Internal Layout

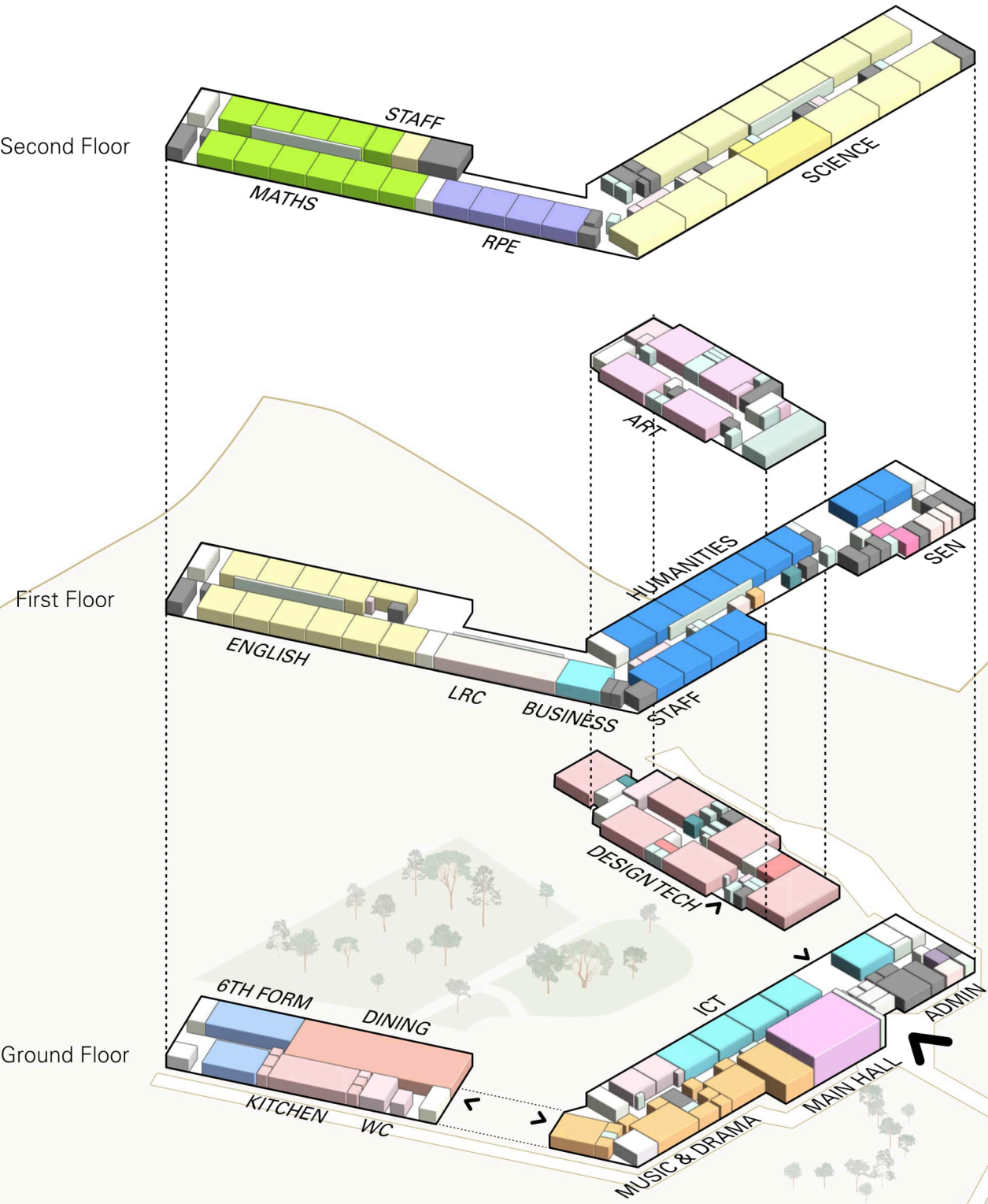

Holy Trinity CofE School Proposed Design Option | Internal Layout - Ground Floor Plan



Holy Trinity CofE School Proposed Design Option | Internal Layout - First Floor Plan



Holy Trinity CofE School Proposed Design Option | Internal Layout - Second Floor Plan

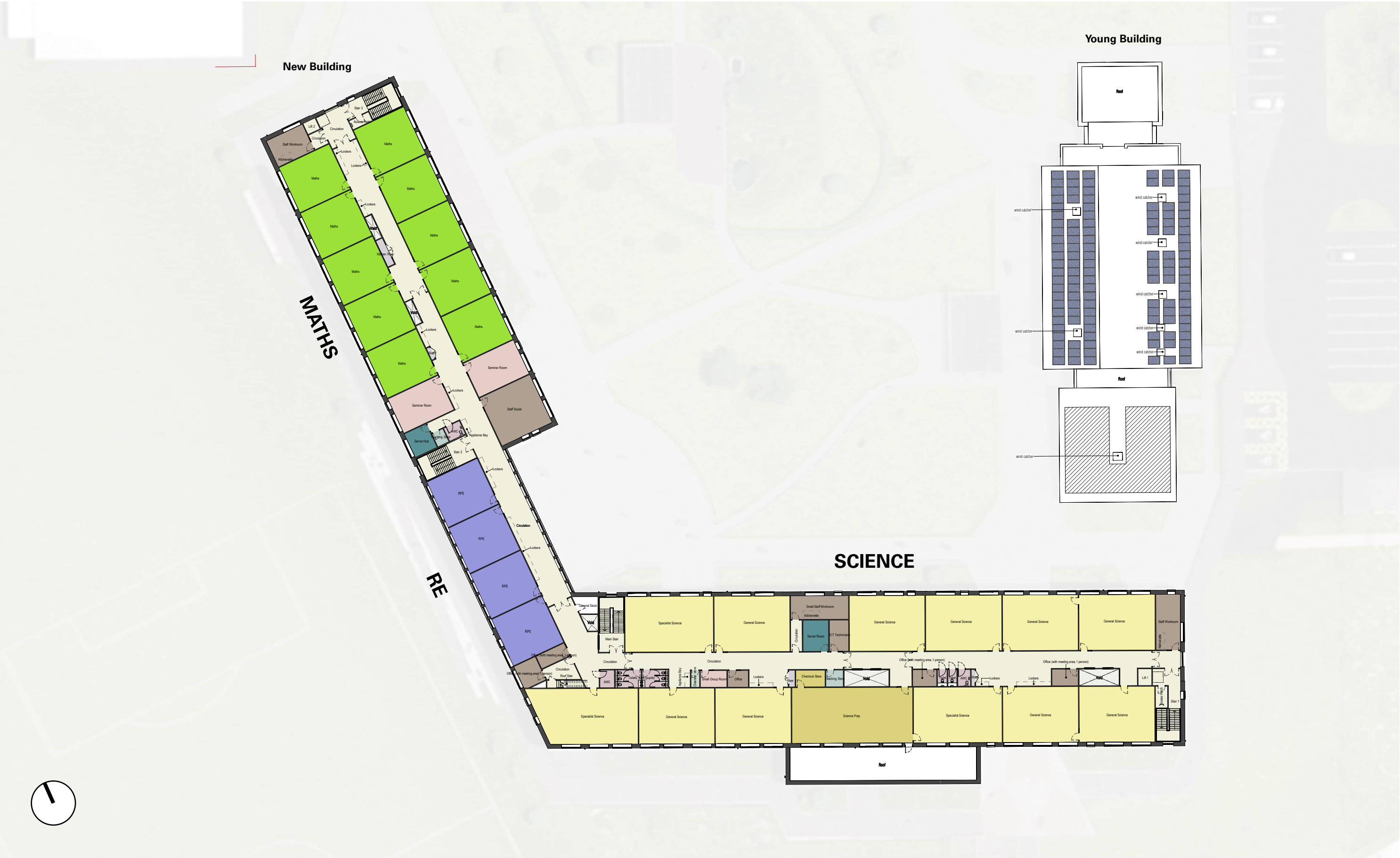

Holy Trinity CofE School Proposed Design Option | View of Future Entrance



Holy Trinity CofE School Proposed Design Option | View of Courtyard



Holy Trinity CofE School Proposed Design Option | View of Bridge Link



Holy Trinity CofE School Proposed Design Option | View from External Student Entrance



Holy Trinity CofE School Proposed Design Option | View from MUGA



Holy Trinity CofE School Phasing | Phase 1

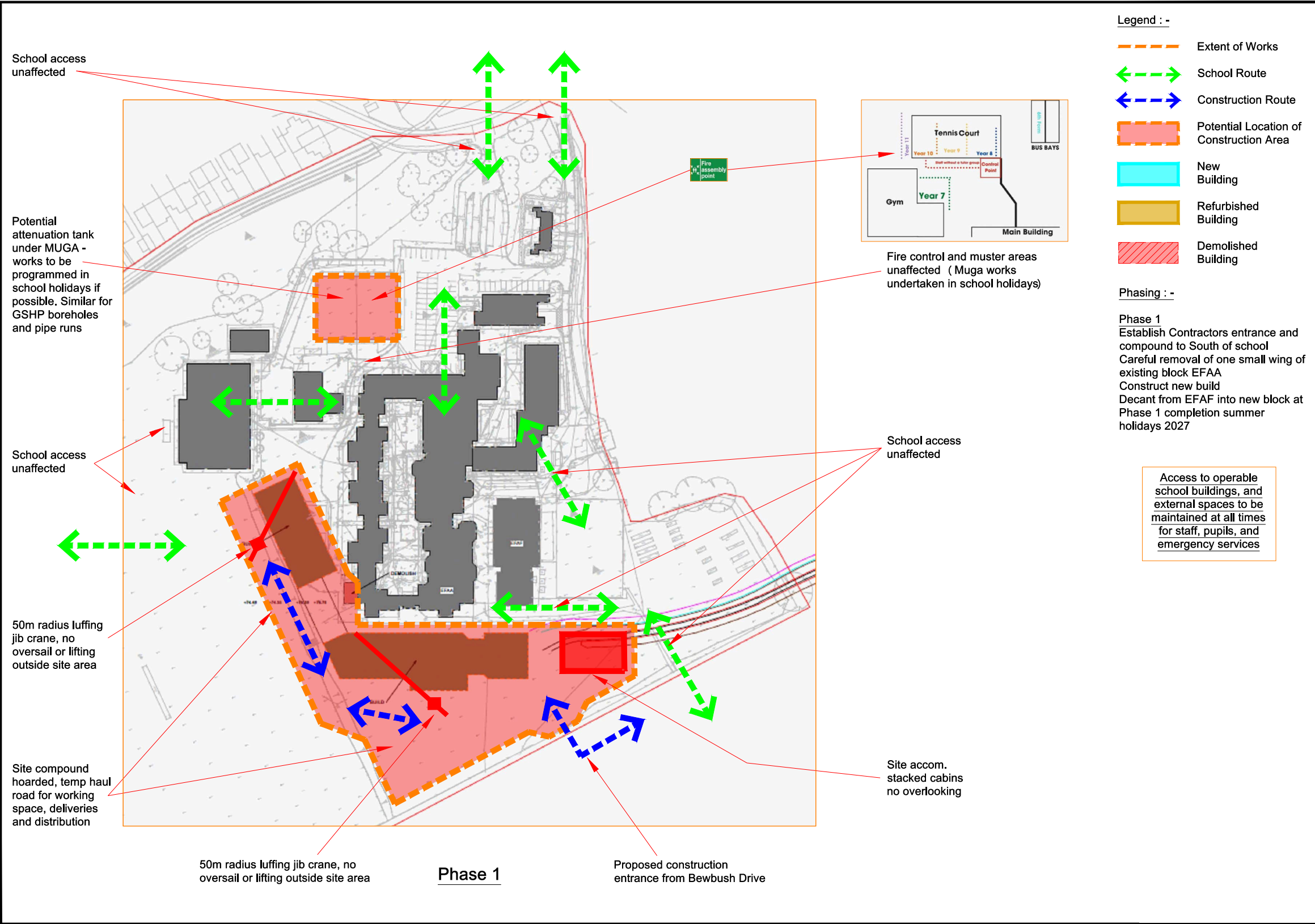

Holy Trinity CofE School Phasing | Phase 2

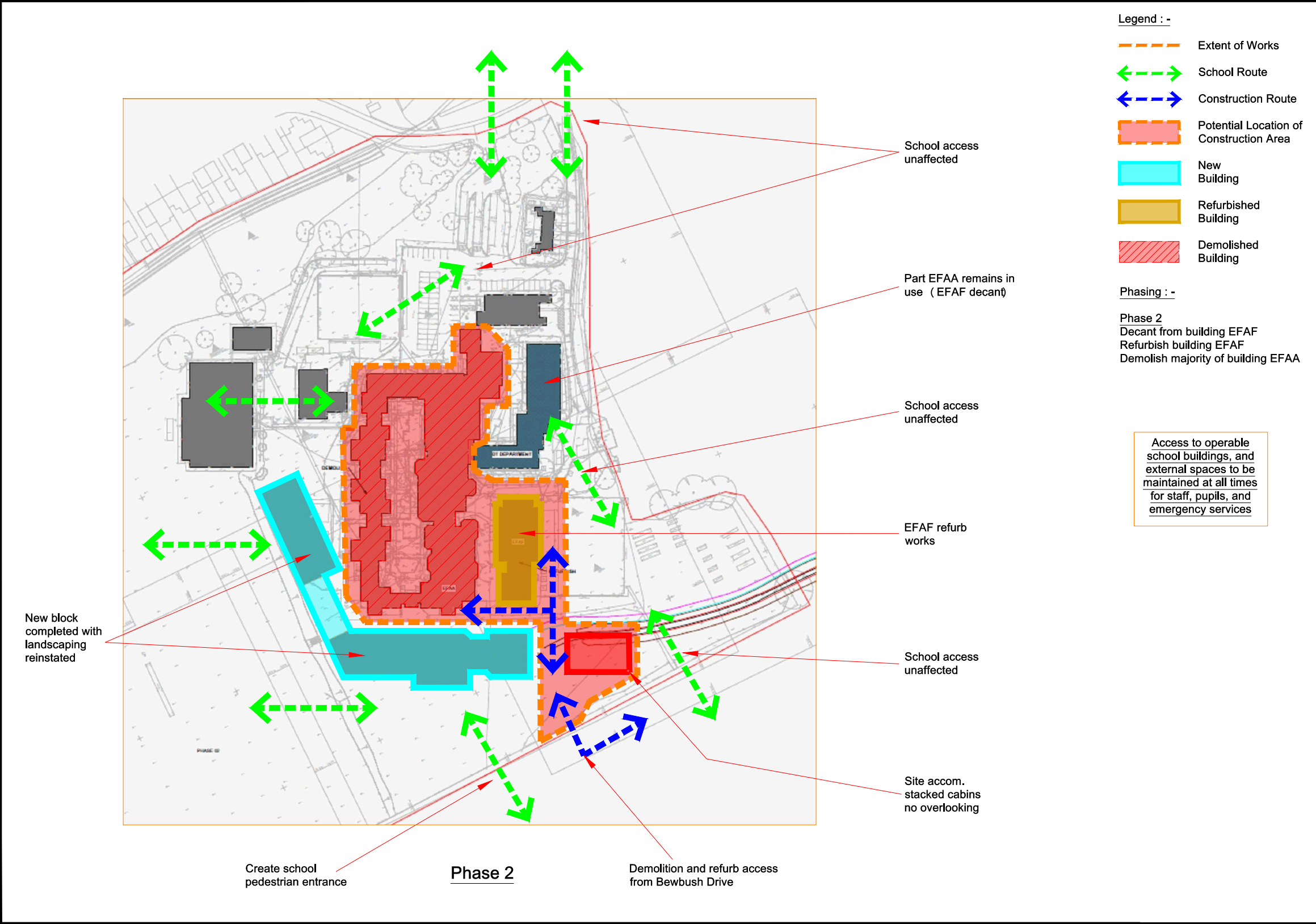

Holy Trinity CofE School Phasing | Phase 3

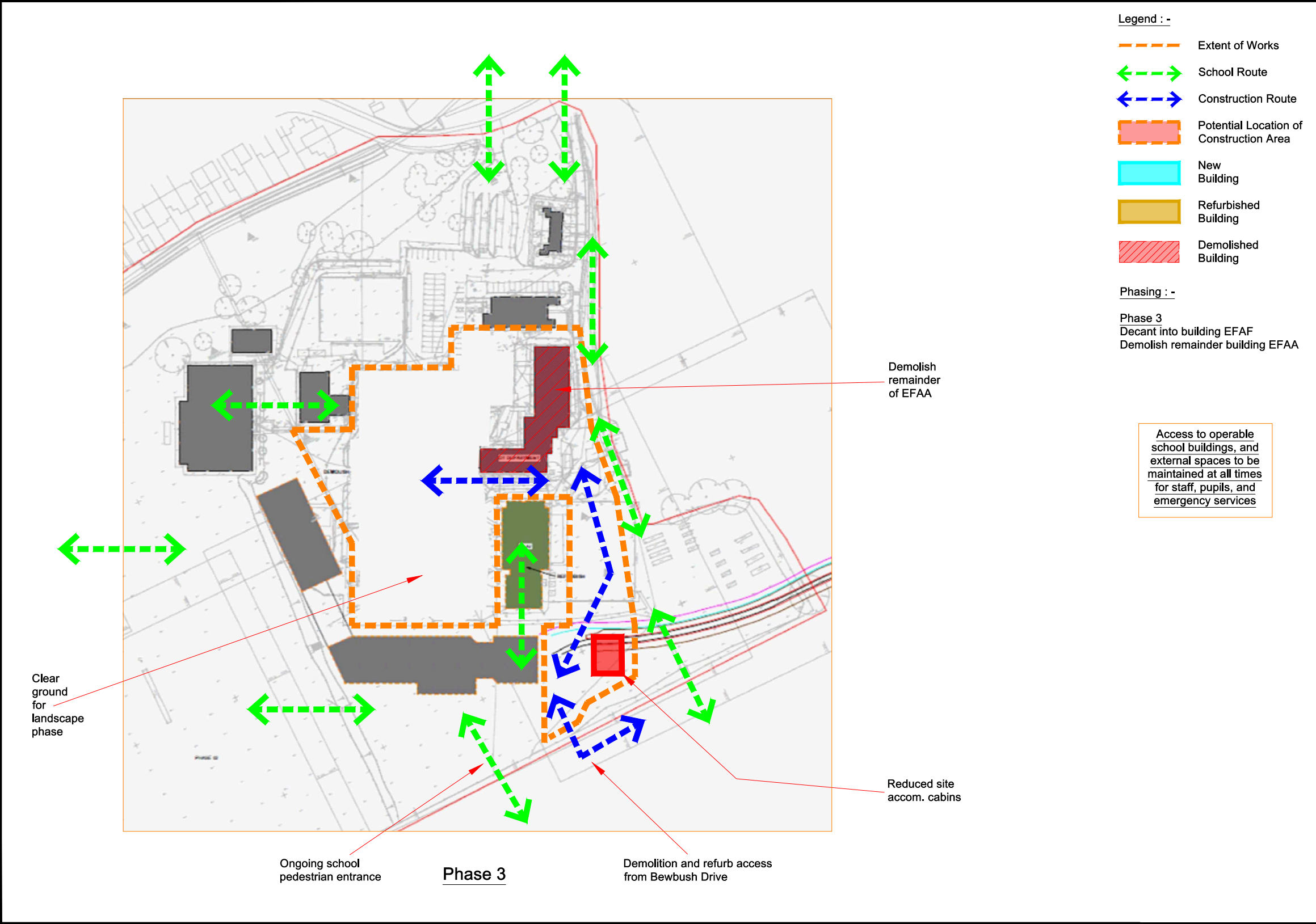

Holy Trinity CofE School Phasing | Phase 4

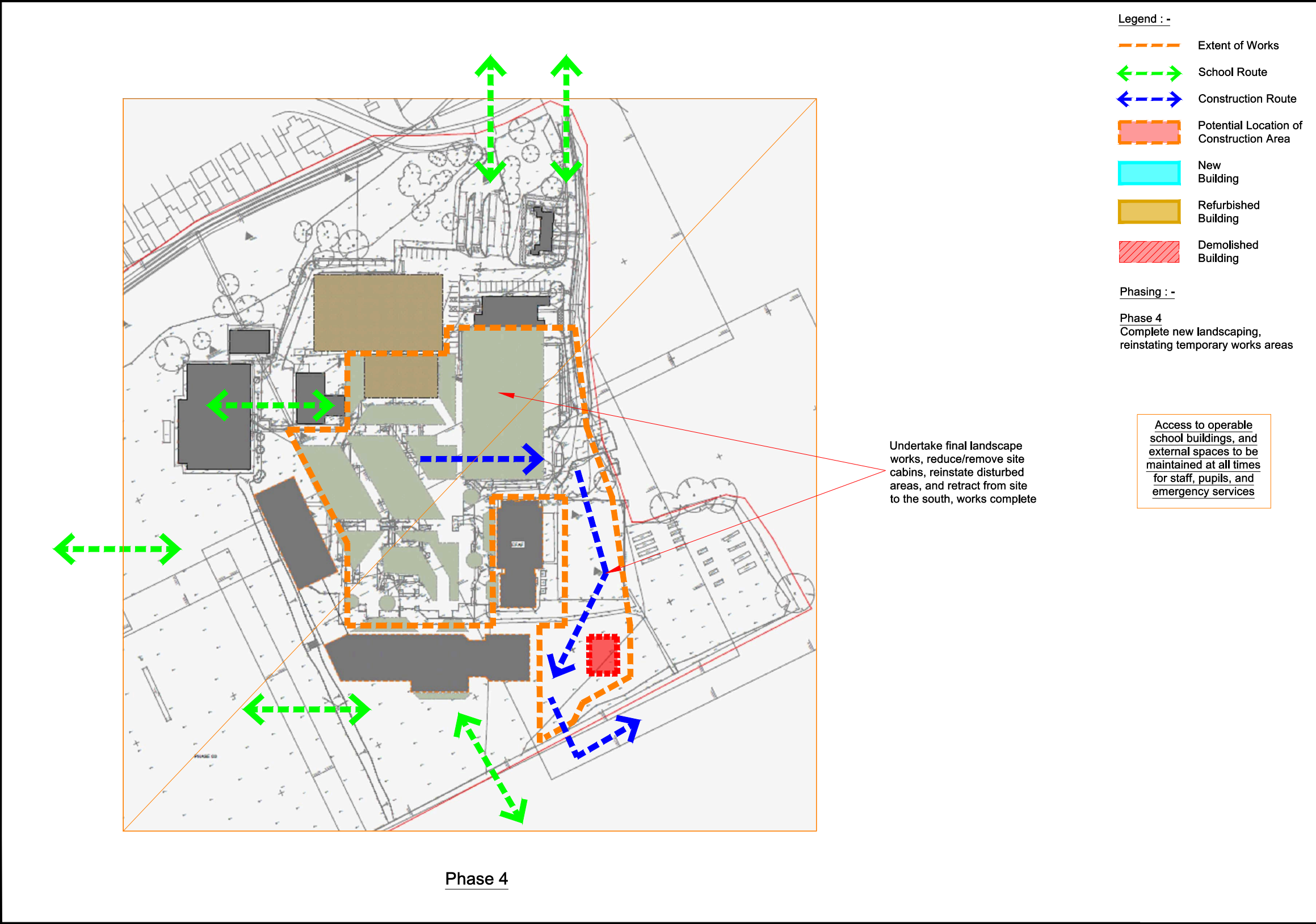

jestico + whites

Sutton Yard 65 Goswell Road
London EC1V 7EN

+44 (0) 20 7380 0382
jesticowhites.com
architecture + interior design
london + prague